

ASPIRA

29 - 31 MOREE STREET
GORDON NSW 2072



SYDNEY INTERNATIONAL
REALTY

1300 747 (SIR) 000 | www.sirealty.com.au



TRUSLAN
GROUP

MODERN ELEGANCE IN DESIGN

OFF THE PLAN
TOWNHOUSES
SELLING NOW!

A NEW APPROACH TO
FAMILY-STYLE LIVING

IMMERSED IN HISTORY.
ABOUNDING IN NATURE.

INSPECTION BY APPOINTMENT
CONTACT SIMA 0416 034 444
OR CRAIG 0402 647 604

Your home. Our passion.

Designed by iRH Designs © 2018



The architecturally-designed Aspira presents a striking contemporary façade, infusing modern design with classic sophistication. Organic materials blend seamlessly with the natural setting and abundant wild-life of the surrounding area. Its emanating style with clean sleek lines and impressive glass frontage, Aspira brings a refreshingly novel approach to high-quality family living in Sydney.



**SYDNEY
INTERNATIONAL
REALTY**

An effortless marriage of comfort and contemporary style, Aspira's luxury living spaces cater to the needs of the modern lifestyle and oozes comfort. The elegant living areas and rich earthy tones emanate warmth and sophistication, offering ample space with flowing wooden floors and plentiful natural light. Plush designer bedrooms feature elegant dark-wood panelling and a soft, subtle colour palette, promoting a sanctuary of calm. Marble-topped surfaces and exquisite finishes display exceptional attention-to-detail to create a premium living experience.

Discover, play, explore... here, families can grow and prosper, with abundant opportunities to embrace a modern family lifestyle in an affluent, community-focused neighbourhood.

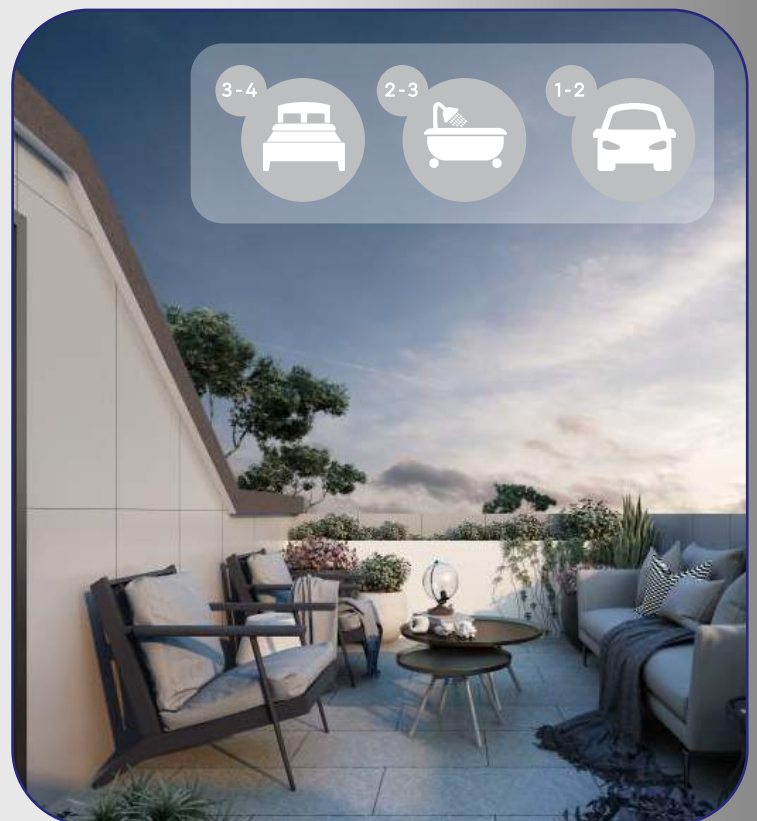

3-4



2-3



1-2



A PRESTIGIOUS NORTH SHORE ADDRESS IN THE HEART OF GORDON



**SYDNEY INTERNATIONAL
REALTY**

SIMA ISRAELI
Director

(02) 9388 2548 | 1300 SIR 000
0416 034 444
www.sirealty.com.au
si_realty@yahoo.com.au

CRAIG YEW
Sales Manager

(02) 9388 2548 | 1300 SIR 000
0402 647 604
www.sirealty.com.au
craigyew@hotmail.com